

OF WESTWOOD COUNTY

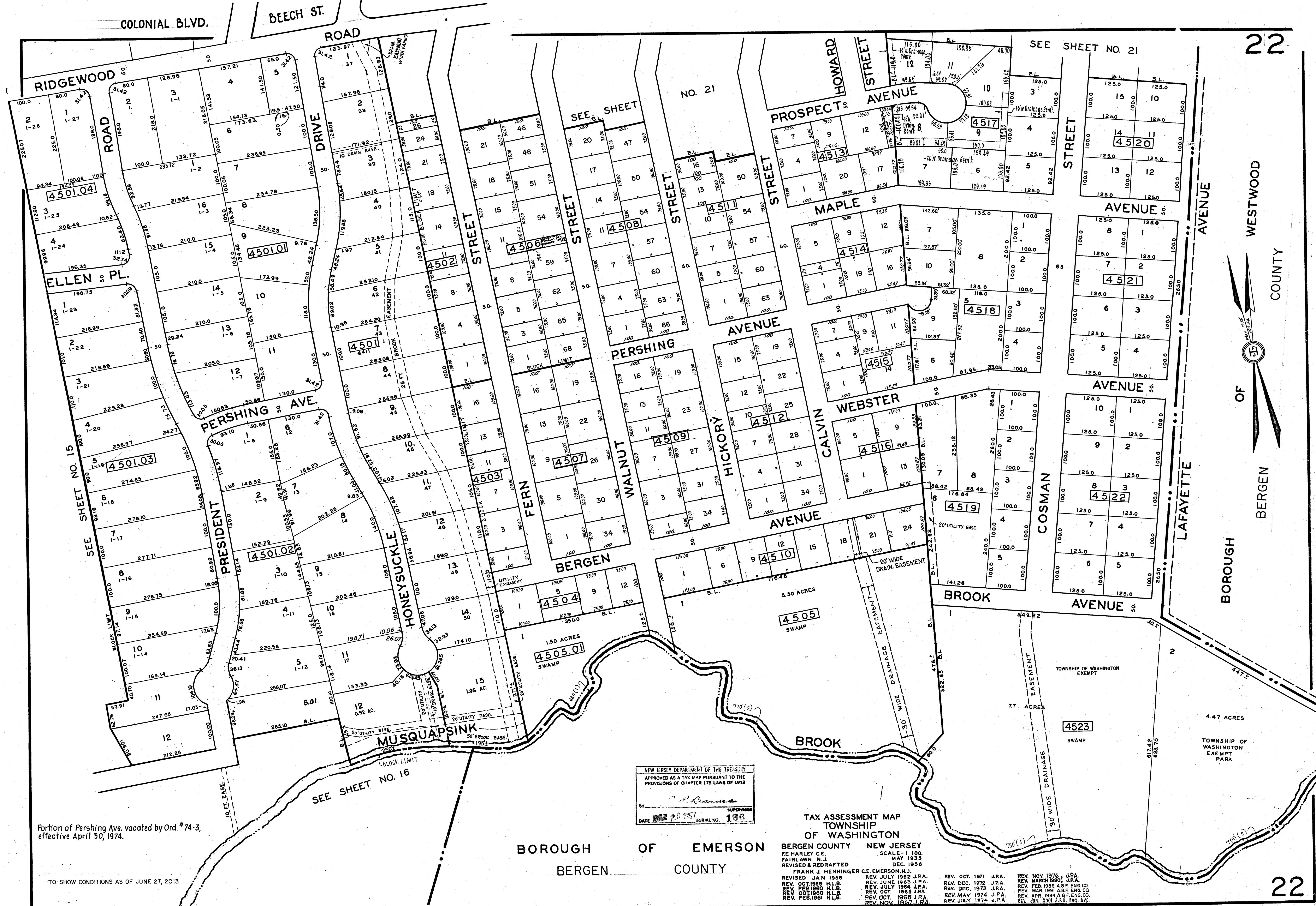

Portion of Pershing Ave. vacated by Ord. #74-3, effective April 30, 1974.

TO SHOW CONDITIONS AS OF JUNE 27, 1913

NEW JERSEY DEPARTMENT OF THE TREASURY  
APPROVED AS A TAX MAP PURSUANT TO THE PROVISIONS OF CHAPTER 175 LAWS OF 1913  
BY *[Signature]*  
DATE 1977 20 2511 SERIAL NO. 136

TAX ASSESSMENT MAP  
TOWNSHIP OF WASHINGTON  
BERGEN COUNTY NEW JERSEY  
FE HARLEY C.E. SCALE - 1" = 100'  
FAIRLAWN N.J. MAY 1935  
REVISED & REDRAFTED DEC. 1956  
FRANK J. HENNINGER C.E. EMERSON, N.J.  
REVISED JAN 1958  
REV OCT 1959 H.L.B.  
REV FEB 1960 H.L.B.  
REV OCT 1960 H.L.B.  
REV FEB 1961 H.L.B.  
REV JULY 1962 J.P.A.  
REV JUNE 1963 J.P.A.  
REV JULY 1964 J.P.A.  
REV OCT 1965 J.P.A.  
REV OCT 1966 J.P.A.  
REV NOV 1967 J.P.A.  
REV OCT 1971 J.P.A.  
REV DEC 1972 J.P.A.  
REV DEC 1973 J.P.A.  
REV MAY 1974 J.P.A.  
REV JULY 1974 J.P.A.  
REV NOV 1976, J.P.A.  
REV MARCH 1980, J.P.A.  
REV FEB 1986 A&F ENG CO.  
REV MAR 1991 A&F ENG CO.  
REV APR 1994 A&F ENG CO.  
REV JAN 2001 A.P.F. Eng. Grp.

BOROUGH OF EMERSON  
BERGEN COUNTY

TOWNSHIP OF WASHINGTON EXEMPT

4.47 ACRES  
TOWNSHIP OF WASHINGTON EXEMPT PARK

7.7 ACRES  
SWAMP

5.50 ACRES  
SWAMP

1.50 ACRES  
SWAMP

MUSQUAPSINK  
BROOK

SEE SHEET NO. 16

SEE SHEET NO. 21

SEE SHEET NO. 21

SEE SHEET NO. 15

NO. 21